



Jesuit Close,, Canterbury

£180,000 Leasehold

2 Bedroom Apartment

Description

This well-presented 2-bedroom apartment in Canterbury offers a fantastic living space, ideal for first-time buyers or as a rental investment.

The spacious living room boasts ample natural light and access to the first of two balconies, perfect for relaxing or entertaining. The large kitchen features a breakfast bar and leads to the second balcony, offering a convenient space for outdoor dining.

Both double bedrooms are generously sized, with built-in wardrobes for added storage. There is also storage in the hallway for added convenience. A family bathroom completes the apartment.

Offered chain-free, this property offers an excellent opportunity for buyers looking for a comfortable and well-located home.

Tenure: Leasehold (89 years)

Tenure

Leasehold



GROUND FLOOR
840 sq.ft. (78.0 sq.m.) approx.

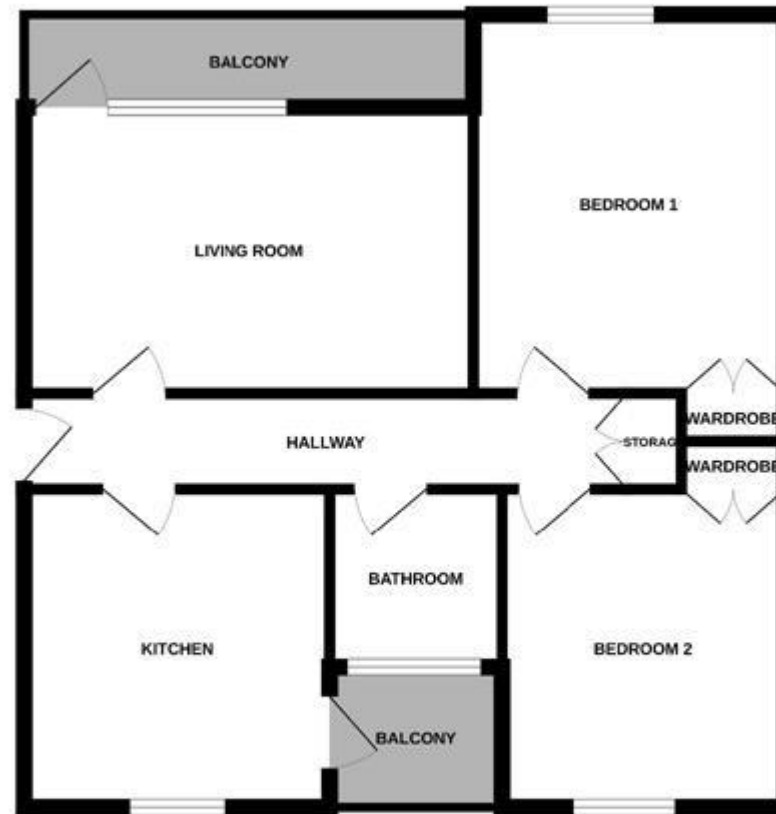

TOTAL FLOOR AREA : 840 sq.ft. (78.0 sq.m.) approx.

While every attempt has been made to ensure the accuracy of the floorplan contained herein, measurements of floor, wall, room and any other items are approximate and no responsibility is taken for any error, omission or misstatement. This plan is for illustrative purposes only and should be used as such by any prospective purchaser. The structure, systems and appliances shown hereon may vary in detail and requirements as to their operability or efficiency can be given.
Made with Metron 0/2024

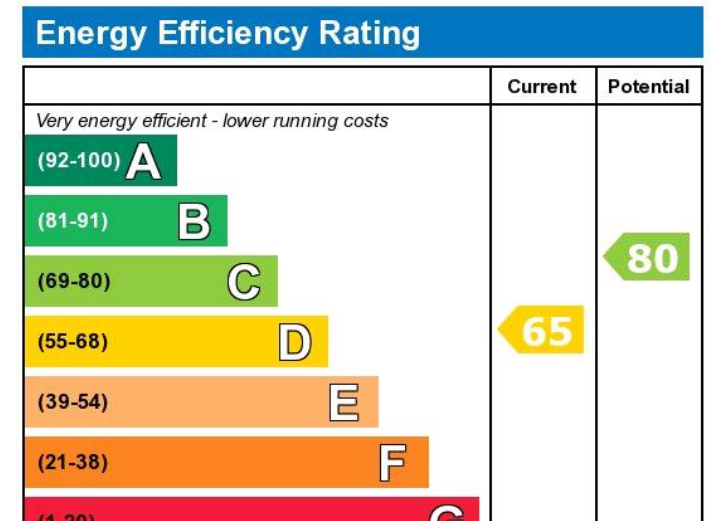

Viewing by appointment only
 Dreams Estate Agency - Head Office
 101 Mortimer Street, Herne Bay, Kent CT6 5ER
 Tel: 01227 467650 Email: info@dreamsestateagency.co.uk Website:
<http://www.dreamsestateagency.co.uk>