



Flat , Mickleburgh Hill, Herne Bay

1 Bedroom Apartment

Offers Over £140,000 Leasehold

Description

This stunning 1 bedroom apartment has a great layout and has been decorated throughout to an impeccable standard.

The large living room has an original feature fireplace and breathtaking views over the famous Herne Bay seafront. It opens up to the fitted kitchen with a range of floor and wall units, along with its own skylight.

The flat has a large double bedroom with plenty of space for additional furniture such as a dressing table and wardrobes. The bathroom has been recently renovated and has a beautiful finish.

This property would be a fantastic first time purchase or even a buy to let investment for someone to move straight in.

Tenure: Leasehold (120 years)

Tenure

Leasehold



GROUND FLOOR
460 sq.ft. (42.7 sq.m.) approx.

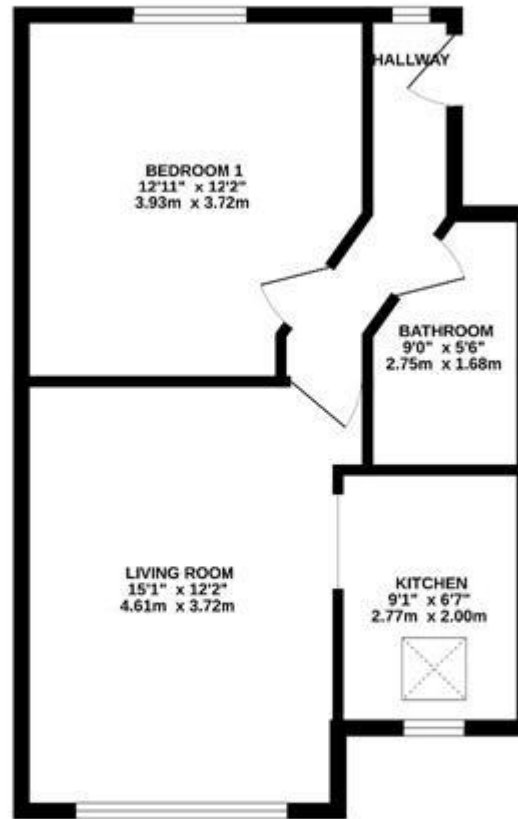

TOTAL FLOOR AREA : 460 sq.ft. (42.7 sq.m.) approx.

While every effort has been made to ensure the accuracy of the floorplan contained herein, measurements of doors, windows, rooms and any other items are approximate and no responsibility is taken for any error, omission or misstatement. This plan is for illustrative purposes only and should be used as such by any prospective purchaser. The materials, systems and appliances shown have not been tested and no guarantee as to their operability or efficiency can be given.
Markwell Interiors ©2022



Energy Efficiency Rating		
	Current	Potential
Very energy efficient - lower running costs		
(92-100) A		
(81-91) B		
(69-80) C	75	80
(55-68) D		
(39-54) E		
(21-38) F		
(1-20) G		

Viewing by appointment only
 Dreams Estate Agency - Head Office
 101 Mortimer Street, Herne Bay, Kent CT6 5ER
 Tel: 01227 467650 Email: info@dreamsestateagency.co.uk Website:
<http://www.dreamsestateagency.co.uk>